



APPLICATION:

## Metal Pipe

ID:

CID:SP-RF-M-02

## INFORMATION:

- Not to scale
- All units are in millimetres
- Tested according EN 1366-3
- [Approval ETA-20/1233](#)

## CFS-CID Cast-in Collar

REV:

01

DATE:

10/2024

## Fire Rating up to EI 180

Page 1/2

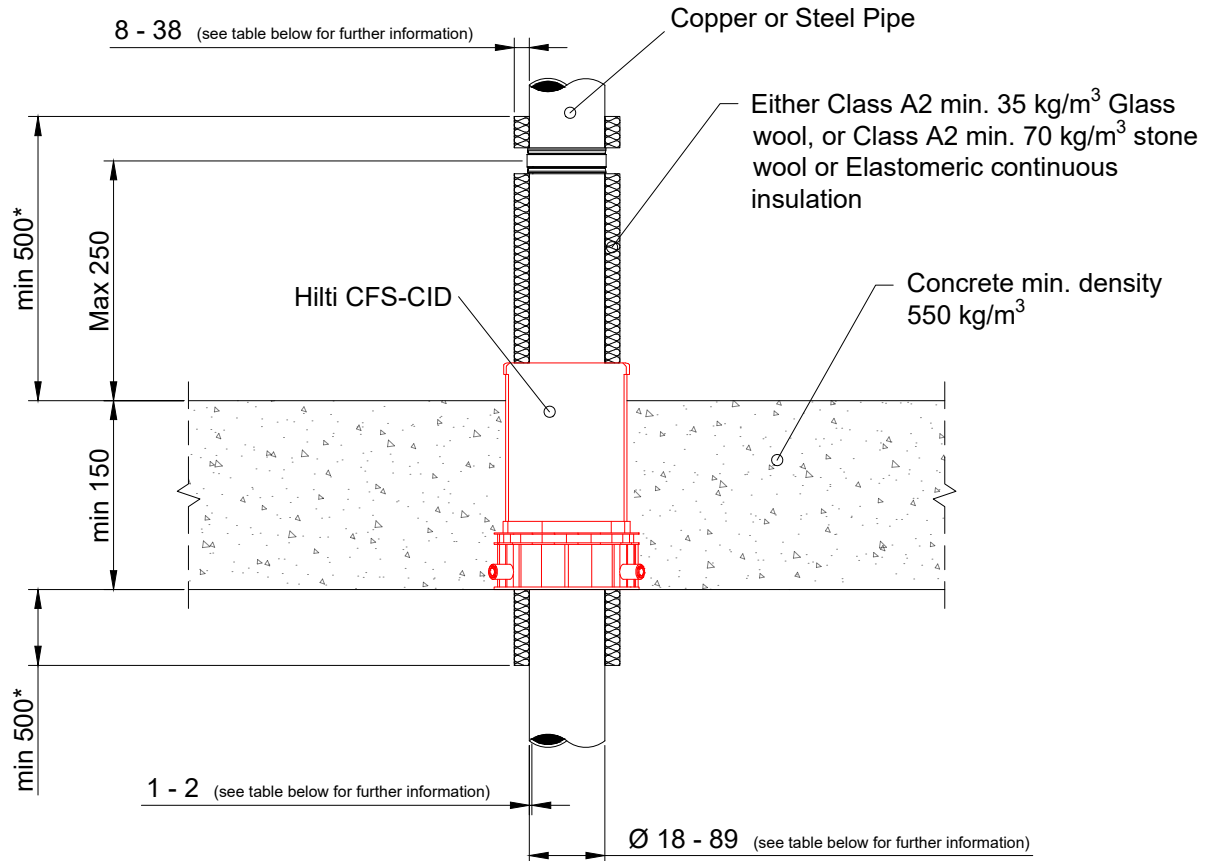

Collar Size	Pipe Diameter	Pipe Wall Thickness	Insulation Type	Pipe Insulation Thickness	Classification with Distance (S <sub>5</sub> ) 0mm	Classification with Distance (S <sub>5</sub> ) 200mm
CFS-CID 50	18 - 28	1 - 1.5	Elastomeric Foamed (CS)	8.0 - 19.0	N / A	EI 180 - C/U
	18	1	Mineral Glasswool (LS)	20	EI 120 - C/U	N / A
	18	1	Mineral Stonewool (LS)	20	N / A	EI 180 - C/U
CFS-CID 75	18	1	Elastomeric Foamed (CS)	32	N / A	EI 180 - C/U
	35	1.5	Mineral Glasswool (LS)	20	EI 120 - C/U	N / A
	35	1.5	Mineral Stonewool (LS)	20	N / A	EI 180 - C/U
CFS-CID 110	42 - 54	1.5 - 2.0	Elastomeric Foamed (CS)	17 - 36.5	N / A	EI 180 - C/U
	76	2	Mineral Glasswool (LS)	20	EI 120 - C/U	N / A
	35	1.5	Mineral Stonewool (LS)	20	N / A	EI 180 - C/U
CFS-CID 160	54 - 76	2	Elastomeric Foamed (CS)	30 - 38	N / A	EI 180 - C/U
	89	2	Mineral Stonewool (LS)	20		

\* For Local Sustained Insulation situation, a minimum length of 500 mm is required.

1. The application limits on this detail are for guidance purposes only. For more detailed information based on the full range of available test results please contact the Hilti Technical Advisory Service.

2. The product and application has been assessed as a minimum to the BS 476 standard. It may have additional European and worldwide testing. Please contact Hilti for further information.

3. All installations should be carried out in accordance with Hilti's installation instructions and by competent & experienced installers using Hilti branded products.

4. All services are to be correctly and adequately supported to prevent collapse and distortion.

Hilti (Gt. Britain) Limited | No 1, Circle Square | 3 Symphony Park | Manchester | M1 7FS

Freephone: 0800 886 100 | Website: [www.hilti.co.uk](http://www.hilti.co.uk)

**LEGAL NOTICE:** This template contains Hilti Intellectual Property which is legally protected, including Community registration of Hilti trademarks. For use only by Hilti customers and in conjunction with Hilti products. No third party use/products is authorised and breaches Hilti's intellectual property rights. Hilti accepts no responsibility for unauthorized use and reserves all rights to take legal action to enforce its rights in law.